

U.S. Army Heritage *and* Education Center

Hours of Operation

Monday - Saturday: 10AM - 5PM

Sunday: 12PM - 5PM

Open Memorial Day, Independence Day, Labor Day, and Veterans Day.
Closed all other Federal Holidays

ahec.armywarcollege.edu

Research Onsite By Appointment + Research Online 24/7



www.facebook.com/USAHEC



www.twitter.com/USAHEC



www.linkedin.com/USAHEC



www.youtube.com/theUSAHEC



U.S. ARMY

950 Soldiers Drive, Carlisle, PA 17013
Phone: 717-245-3972

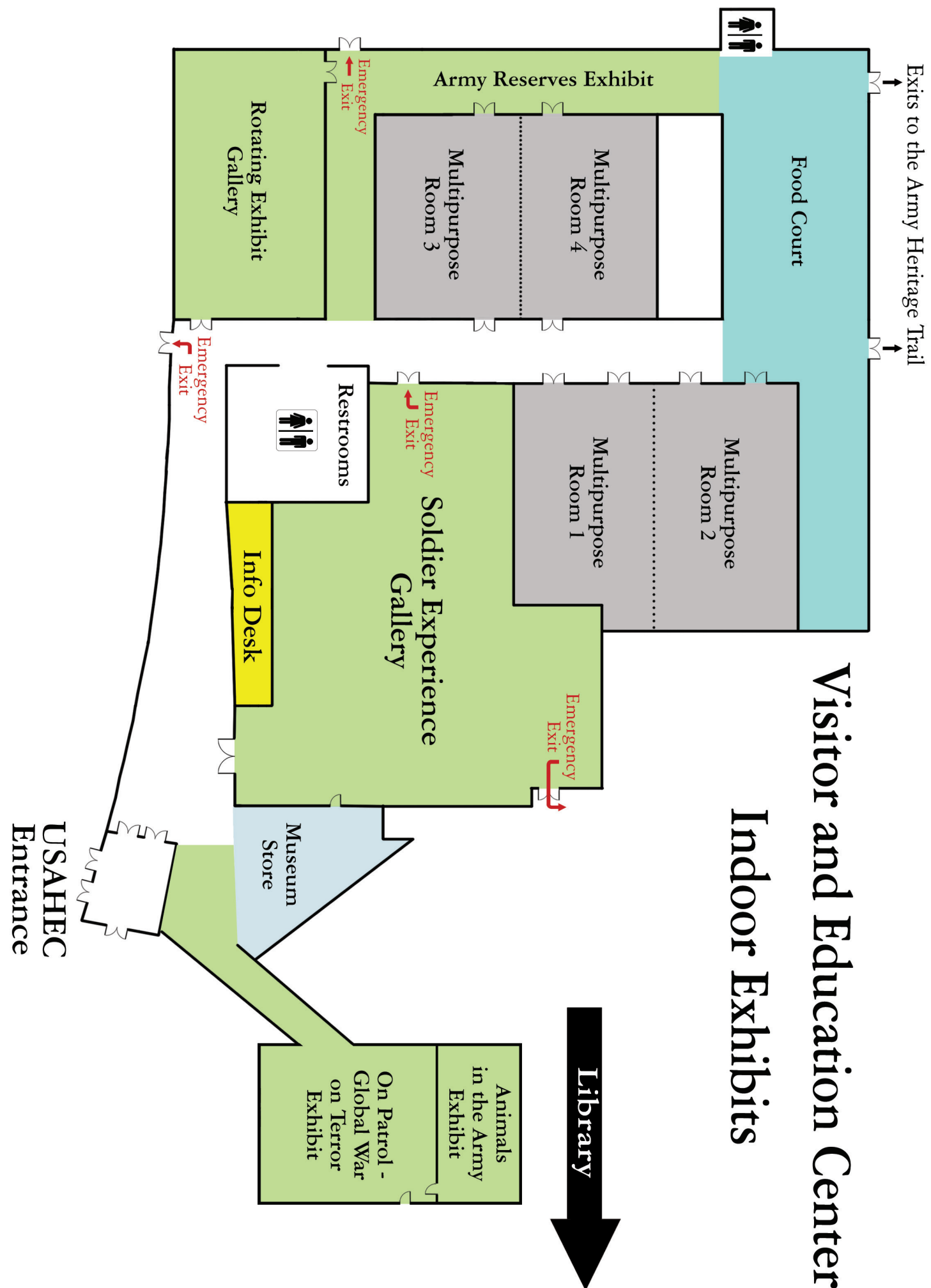

Army Heritage Trail

Open Dawn to Dusk

Trail Buildings Close at 4:00pm

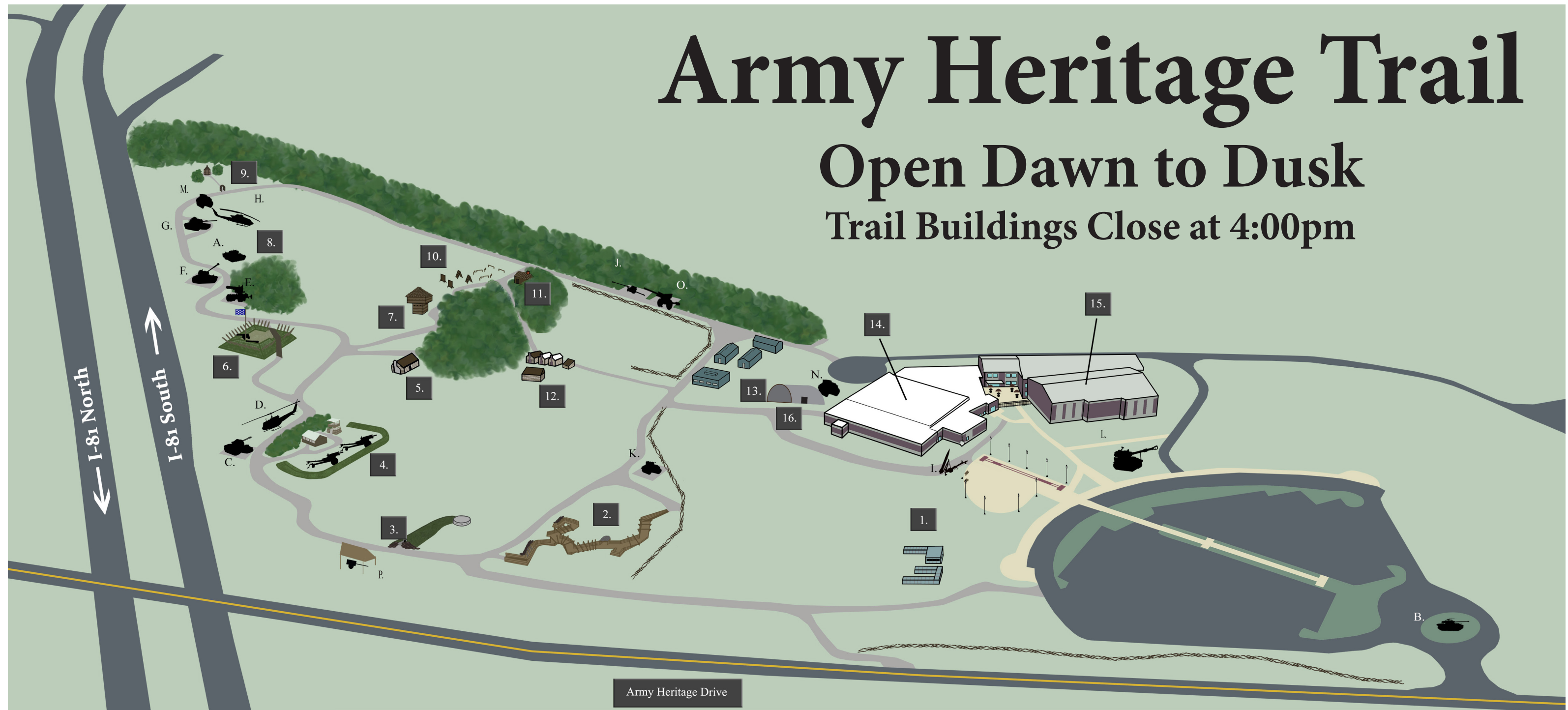

Army Heritage Trail Exhibit Areas:

- | | |
|-------------------------------------|--|
| 1. Global War on Terror | 9. Memorial Garden |
| 2. World War I Allied Trench | 10. World War II Obstacle Course |
| 3. World War I German Pillbox | 11. Carlisle Forge Blacksmith Shop |
| 4. Vietnam Firebase | 12. Civil War Winter Cabins |
| 5. French and Indian War Waystation | 13. World War II Induction Center |
| 6. Revolutionary War Redoubt #10 | 14. Visitor and Education Center (VEC) |
| 7. War of 1812 Blockhouse | 15. Ridgway Hall |
| 8. Cold War Area | 16. Pavilion |

Army Heritage Trail Equipment:

- | | |
|---|------------------------------------|
| A. Bradley Fighting Vehicle | L. M109 A5 Self-Propelled Howitzer |
| B. M18 Tank Destroyer "Hellcat" | M. M113 Armored Personnel Carrier |
| C. M42 Self-Propelled Anti-Aircraft Gun | N. 577 Command Post Carrier |
| D. UH-1 Iroquois "Huey" Helicopter | O. M5/ M6 Anti tank gun |
| E. 8 Inch Howitzer, M1 | P. M1819 Communications Cart |
| F. M46 "Tiger" Tank | |
| G. M60 "Patton" Main Battle Tank | |
| H. AH-1 Cobra Helicopter | |
| I. MGM-52 Lance Missile | |
| J. German PAK 43/41 | |
| K. M4 Sherman Tank | |